

Technical specification

Mounting torque: max. 25 Nm
Ambient temperature: -40°C ... +125°C
Media temperature: -40°C ... +125°C

Type label description

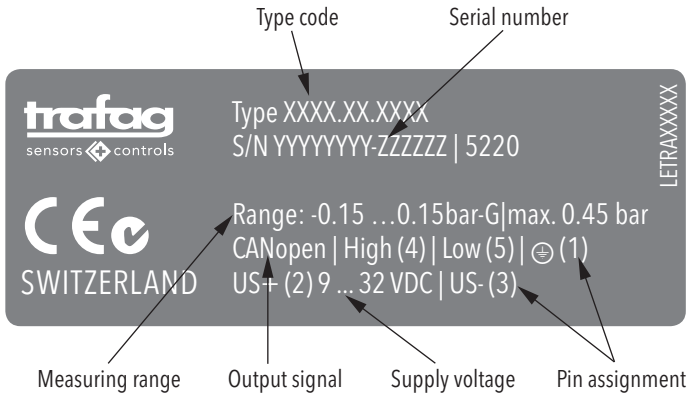

Electrical connections

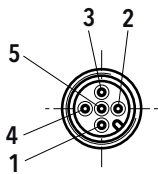

Pin	Out
1	⊖
2	Us+ (24VDC)
3	Us- (0 VDC)
4	CAN_High
5	CAN_Low

CANopen-protocol

Output signal: CAN BUS (ISO 118982)
CANopen: DS-301 V4.0
Device profile: DS 404-1 V1.2
Baudrate: 10 kbit/s
20 kbit/s
50 kbit/s
125 kbit/s
250 kbit/s
500 kbit/s
800 kbit/s
1 Mbit/s
Automatic bit rate detection
Node ID: 1 ... 127

Electrical connection

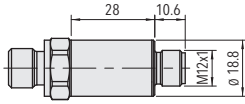

8271.XX.XXXX[35]XX.XX

Pressure connections

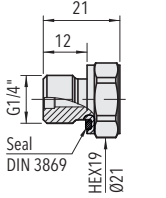

8271.XX.XX[17]XX

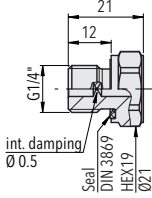

8271.XX.XX[15]XX

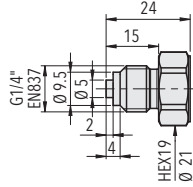

8271.XX.XX[53]XX

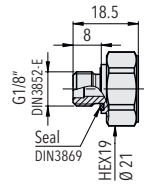

8271.XX.XX[54]XX

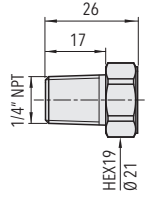

8271.XX.XX[30]XX

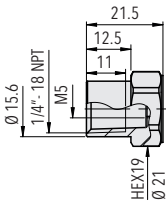

8271.XX.XX[13]XX

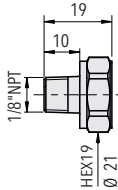

8271.XX.XX[43]XX

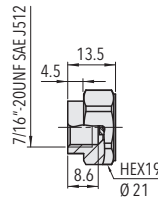

8271.XX.XX[24]XX

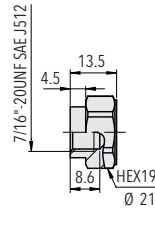

8271.XX.XX[44]XX

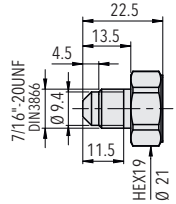

8271.XX.XX[18]XX

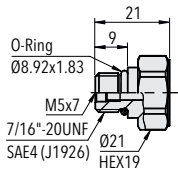

8271.XX.XX[42]XX

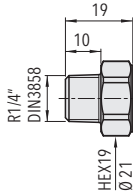

8271.XX.XX[19]XX

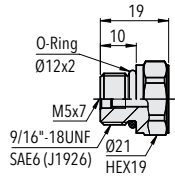

8271.XX.XX[61]XX

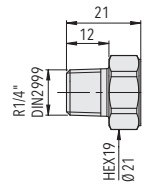

8271.XX.XX[20]XX

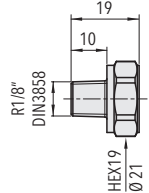

8271.XX.XX[16]XX

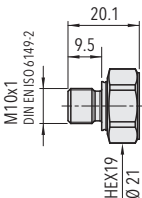

8271.XX.XX[32]XX

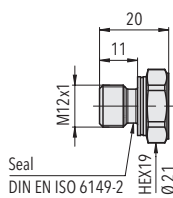

8271.XX.XX[64]XX

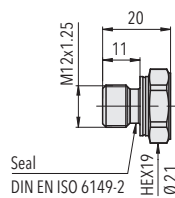

8271.XX.XX[65]XX

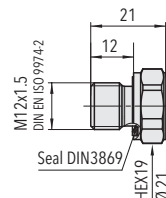

8271.XX.XX[49]XX

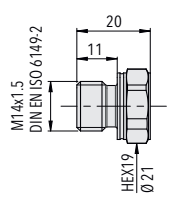

8271.XX.XX[31]XX