

# ECONOMIC REFRIGERATION PRESSURE TRANSMITTER

This product will be replaced by: ECT 8472 - see [www.trafag.com/H72324](http://www.trafag.com/H72324)  
EPI 8287 - see [www.trafag.com/H72317](http://www.trafag.com/H72317)

Swiss based Trafag is a leading international supplier of high quality sensors and monitoring instruments for measurement of pressure and temperature.



## Applications

- HVAC
- Refrigeration

## Features

- Economical
- Good media compatibility
- Relative or absolute pressure measurement

| Technical Data      |   |                      |   |
|---------------------|---|----------------------|---|
| Measuring principle | Thick film on ceramic   | Accuracy @ 25°C typ. | ± 0.5 % FS typ.                                 |
| Measuring range     | -1 ... 9 to 0 ... 40 bar<br>0 ... 15 to 0 ... 500 psi                           | Media temperature    | -25°C ... +125°C                                |
| Output signal       | 4 ... 20 mA, 0 ... 5 VDC, 1 ... 6 VDC,<br>0 ... 10 VDC, 0.5 ... 4.5 VDC ratiom. | Ambient temperature  | -25°C ... +85°C<br>Cable PVC 22: -5°C ... +60°C |

10/2017

Data sheet H72323aa

Subject to change

## Ordering information/type code

|  |   |                                    |                             | 8471 . XX         |   |                            |                             | XX        | XX | XX | XX | XX        |
|--|---|------------------------------------|-----------------------------|-------------------|---|----------------------------|-----------------------------|-----------|----|----|----|-----------|
| <b>Measuring range <sup>1)</sup></b>   | <b>Pressure measurement range [bar]</b>   | <b>Over pressure [bar]</b>         | <b>Burst pressure [bar]</b> |                   | <b>Pressure measurement range [psi]</b> | <b>Over pressure [psi]</b> | <b>Burst pressure [psi]</b> |           |    |    |    |           |
|  | 0 ... 1.0   | 2                                  | 3                           | <b>71</b>         | 0 ... 15                                | 30                         | 40                          | <b>G1</b> |    |    |    |           |
|  | 0 ... 1.6   | 3.2                                | 4.8                         | <b>73</b>         | 0 ... 20                                | 45                         | 70                          | <b>G3</b> |    |    |    |           |
|  | 0 ... 2.5   | 5                                  | 7.5                         | <b>75</b>         | 0 ... 30                                | 60                         | 90                          | <b>G5</b> |    |    |    |           |
|  | 0 ... 4   | 8                                  | 12                          | <b>76</b>         | 0 ... 50                                | 100                        | 150                         | <b>G6</b> |    |    |    |           |
|  | 0 ... 6   | 12                                 | 15                          | <b>77</b>         | 0 ... 100                               | 200                        | 250                         | <b>G7</b> |    |    |    |           |
|  | 0 ... 10  | 20                                 | 25                          | <b>78</b>         | 0 ... 150                               | 300                        | 375                         | <b>G8</b> |    |    |    |           |
|  | 0 ... 16  | 32                                 | 40                          | <b>79</b>         | 0 ... 250                               | 500                        | 625                         | <b>G9</b> |    |    |    |           |
|  | 0 ... 25  | 50                                 | 75                          | <b>80</b>         | 0 ... 400                               | 800                        | 1200                        | <b>H0</b> |    |    |    |           |
|  | 0 ... 40  | 80                                 | 100                         | <b>81</b>         | 0 ... 500                               | 1000                       | 1250                        | <b>H1</b> |    |    |    |           |
|  | -1 ... 9  | 20                                 | 25                          | <b>26</b>         |   |                            |                             |           |    |    |    |           |
|  | -1 ... 16   | 32                                 | 40                          | <b>27</b>         |   |                            |                             |           |    |    |    |           |
| <b>Sensor</b>  | Relative pressure, Material pressure connection and housing: 1.4305 (AISI303)               |                                    |                             |                   |   |                            |                             | <b>57</b> |    |    |    |           |
|  | Absolute pressure, Material pressure connection and housing: 1.4305 (AISI303) <sup>2)</sup> |                                    |                             |                   |   |                            |                             | <b>87</b> |    |    |    |           |
| <b>Pressure connection</b>   | 7/16"-20UNF male, DIN3866   |                                    |                             |                   |   |                            |                             | <b>18</b> |    |    |    |           |
|  | 7/16"-20UNF female SAE J512 with valve opener   |                                    |                             |                   |   |                            |                             | <b>24</b> |    |    |    |           |
|  | 1/4" NPT male, ANSI B1.20.1 <sup>3)</sup>   |                                    |                             |                   |   |                            |                             | <b>30</b> |    |    |    |           |
| <b>Electrical connection</b>   | Male electrical plug EN 175301-803-A, Mat. PA   |                                    |                             |                   |   |                            |                             | <b>05</b> |    |    |    |           |
|  | Male electrical plug M12x1, 5-pole, Mat. PA   |                                    |                             |                   |   |                            |                             | <b>35</b> |    |    |    |           |
|  | Male electrical plug Packard Metri Pack, Mat. PBT <sup>6)</sup>                             |                                    |                             |                   |   |                            |                             | <b>51</b> |    |    |    |           |
|  | Male electrical plug, industrial standard (contact distance 9.4 mm) Mat. PBT                |                                    |                             |                   |   |                            |                             | <b>01</b> |    |    |    |           |
|  | Cable IP67, Mat. PVC (cable gland PA6-3), -5°C ... +60°C <sup>4) 5)</sup>                   |                                    |                             |                   |   |                            |                             | <b>22</b> |    |    |    |           |
| Cable IP68, Mat. PVC, max. 3m, Medium +10°C ... +35°C, Pmax. 1 bar rel./abs. (old version) |   |                                    |                             |                   |   |                            | <b>68</b>                   |           |    |    |    |           |
| <b>Output signal</b>   | <b>Signal output</b>  | <b>Load resistance</b>             |                             | <b>I (supply)</b> | <b>U (supply)</b>                       |                            |                             |           |    |    |    |           |
|  | 4 ... 20 mA   | (U <sub>supply</sub> -9 V) / 20 mA |                             |                   | 9 ... 30 VDC                            |                            |                             |           |    |    |    | <b>19</b> |
|  | 0 ... 5 VDC   | ≥ 2.5 kΩ                           |                             | ≤ 10 mA           | 10 ... 30 VDC                           |                            |                             |           |    |    |    | <b>14</b> |
|  | 1 ... 6 VDC   | ≥ 5.0 kΩ                           |                             | ≤ 10 mA           | 10 ... 30 VDC                           |                            |                             |           |    |    |    | <b>16</b> |
|  | 0 ... 10 VDC  | ≥ 5.0 kΩ                           |                             | ≤ 10 mA           | 15 ... 30 VDC                           |                            |                             |           |    |    |    | <b>17</b> |
|  | 0.5 ... 4.5 VDC ratiometric   | ≥ 5.0 kΩ                           |                             | ≤ 10 mA           | 5 VDC ± 0.25 VDC ratiom.                |                            |                             |           |    |    |    | <b>23</b> |

| Accessories  |  |    |
|--|--|----|
| Seal FKM (-20°C ... +125°C)  |  | 61 |
| Seal CR ≤ 100 bar (-25°C ... +100°C)   |  | 62 |
| Seal EPDM (-25°C ... +125°C)   |  | 63 |
| Pressure peak damping element ø 1.0 mm <sup>7)</sup>   |  | 40 |
| Pressure peak damping element ø 0.3 mm <sup>7)</sup>   |  | 43 |
| Pressure peak damping element ø 0.4 mm <sup>7)</sup>   |  | 44 |
| Pressure peak damping element ø 0.5 mm <sup>7)</sup>   |  | 45 |
| Female electrical connector EN 175301-803-A (DIN43650-A)   |  | 58 |
| Female electrical plug M12x1, 5-pole   |  | 33 |
| Female electrical connector industrial standard  |  | 34 |
| Special electrical connection: Pin 1 + , Pin 2 -<br>(only for output signal 4 ... 20 mA and male electrical plug EN175301-803-A / DIN43650-A)                |  | 92 |
| Special electrical connection: Pin 1 + , Pin 2 -, Pin 3 out<br>(only for output signals 14, 16, 17, 23 and male electrical plug EN175301-803-A / DIN43650-A) |  | 97 |
| Special electrical connection: Pin 1 + , Pin 2 -, Pin 3 out<br>(only for output signals 14, 16, 17, 23 and male electrical plug EN175301-803-A / DIN43650-A) |  | 98 |
| Special electrical connection: Pin 1 + , Pin 3 -<br>(only for output 4 ... 20 mA and male electrical plug Packard Metri Pack 3-poles)                        |  | E4 |
| Special electrical connection: Pin 1 + , Pin 2 out Pin 3 -<br>(only for output signals 14, 16, 17, 23 and male electrical plug Packard Metri Pack 3-poles)   |  | 99 |
| Cable length 1.5 m   |  | 1M |
| Cable length 3.0 m   |  | 3M |
| Cable length 5.0 m   |  | 5M |

<sup>1)</sup> Extended overpressure as well as customized pressure ranges upon request

<sup>2)</sup> Absolute ranges max. 40 bar

<sup>3)</sup> Please ask us

<sup>4)</sup> Cable length see accessories

<sup>5)</sup> More materials and cables with venting tubes for low pressure ranges upon request

<sup>6)</sup> Pressure ranges > 16 bar (Pressure ranges ≤ 16 bar upon request)

<sup>7)</sup> Only for pressure connection 30

 Identical construction for industries and optional with higher accuracy:  
Data sheets No. H72324 and H72326

## Standard products (extra short lead time)

| Product No. | Type Code                             | Pressure range [bar] | Over pressure max. [bar] | Signal output | Supply [VDC] |
|-------------|---------------------------------------|----------------------|--------------------------|---------------|--------------|
| ECTR9.0A    | 8471 26 5718 05 0000 0000 19 58 62 01 | -1 ... 9             | 20                       | 4 ... 20 mA   | 9 ... 30     |
| ECTR16.0A   | 8471 27 5718 05 0000 0000 19 58 62 01 | -1 ... 16            | 32                       | 4 ... 20 mA   | 9 ... 30     |
| ECTR25.0A   | 8471 80 5718 05 0000 0000 19 58 62    | 0 ... 25             | 50                       | 4 ... 20 mA   | 9 ... 30     |
| ECTR30.0A   | 8471 29 5718 05 0000 0000 19 58 62 01 | 0 ... 30             | 50                       | 4 ... 20 mA   | 9 ... 30     |
| ECTR9.0A    | 8471 26 5724 05 0000 0000 19 58 62 01 | -1 ... 9             | 20                       | 4 ... 20 mA   | 9 ... 30     |
| ECTR16.0A   | 8471 27 5724 05 0000 0000 19 58 62 01 | -1 ... 16            | 32                       | 4 ... 20 mA   | 9 ... 30     |
| ECTR25.0A   | 8471 80 5724 05 0000 0000 19 58 62    | 0 ... 25             | 50                       | 4 ... 20 mA   | 9 ... 30     |

| Specifications                  |  |  |
|---------------------------------|--|--|
| <b>Accuracy</b>                 | TEB typ. @ -25 ... +85°C   | ± 3.0 % FS typ.  |
|                                 | Accuracy @ 25°C typ.   | ± 0.5 % FS typ.  |
|                                 | NLH @ 25°C (BSL) typ.  | ± 0.2 % FS typ.  |
|                                 | TC zero point and span typ.  | ± 0.03 % FS/K typ.   |
|                                 | Long term stability 1 year typ.  | ± 0.3 % FS typ.  |
| <b>Electrical Data</b>          | Output / supply voltage  | 4...20 mA: 24 (9...30) VDC<br>0...5 VDC: 24 (10...30) VDC<br>1...6 VDC: 24 (10...30) VDC<br>0...10 VDC: 24 (15...30) VDC<br>0.5...4.5 VDC ratiometric: 5 VDC |
|                                 | Rise time  | Typ. 1 ms / 10 ... 90 % nominal pressure   |
|                                 | Switch-on-delay  | Max. 1.5 s   |
|                                 | Inverse-polarity protection, short-circuit strength @ 25°C during 5 min. | 4...20 mA: to $U_s = 30$ VDC<br>0...10 VDC, 0...5 VDC, 1...6 VDC: to $U_s = 30$ VDC<br>0.5...4.5 VDC ratiometric: to $U_s = 5.25$ VDC                        |
| <b>Environmental conditions</b> | Media temperature  | -25°C ... +125°C   |
|                                 | Ambient temperature  | -25°C ... +85°C<br>(Cable PVC 22: -5°C ... +60°C)  |
|                                 | Protection <sup>1)</sup>   | IP65, IP67, IP68   |
|                                 | Humidity   | Max. 95 % relative   |
|                                 | Vibration  | 4 g (10...2000 Hz)   |
|                                 | Shock  | 50 g / 8 ms  |
| <b>EMC Protection</b>           | Emission   | EN/IEC 61000-6-3   |
|                                 | Immunity   | EN/IEC 61000-6-2   |
| <b>Mechanical Data</b>          | Sensor (wetted parts)  | Ceramic, Al <sub>2</sub> O <sub>3</sub> (96 %)   |
|                                 | Pressure connection (wetted parts)                                       | 1.4305 (AISI303)   |
|                                 | Housing  | 1.4305 (AISI303)   |
|                                 | Sealing  | FKM 70 Sh, CR, EPDM  |
|                                 | Male electrical plug   | See ordering information   |
|                                 | Weight   | ~ 110 g  |
|                                 | Mounting torque  | 15...20 Nm   |

<sup>1)</sup> See electrical connection

## Measuring accuracy 0.5%

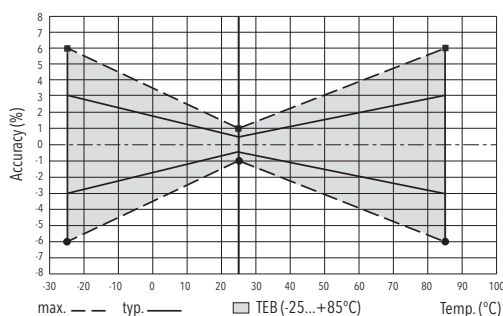

## Dimensions

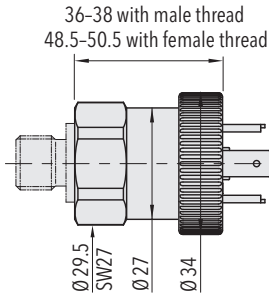

8471.XX.XXXX.05.XX.XX

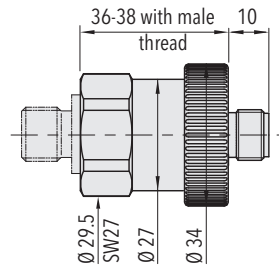

8471.XX.XXXX.35.XX.XX

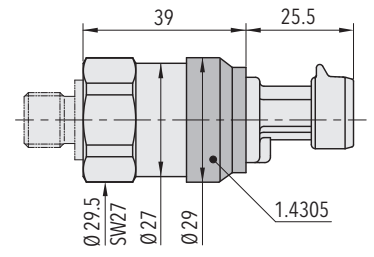

8471.XX.XXXX.51.XX.XX

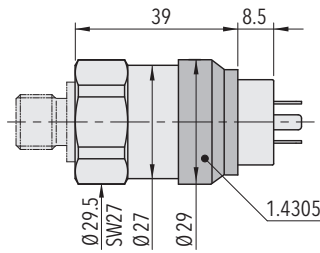

8471.XX.XXXX.01.XX.XX

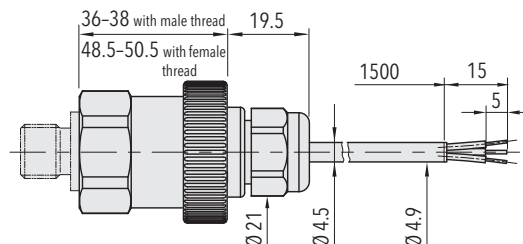

8471.XX.XXXX.22/68.XX.XX

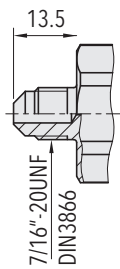

8471.XX.XX18.XX.XX.XX

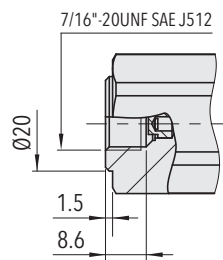

8471.XX.XX24.XX.XX.XX

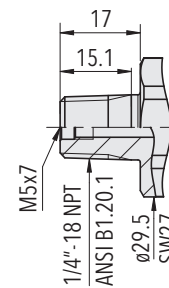

8471.XX.XX30.XX.XX.XX

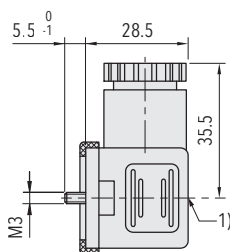

1) Tightening torque 50...60Ncm

8471.XX.XXXX.XX.XX.58

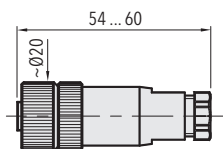

8471.XX.XXXX.XX.XX.33

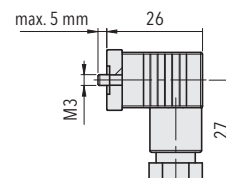

8471.XX.XXXX.XX.XX.34

## Electrical connection

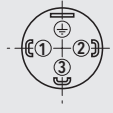
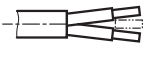
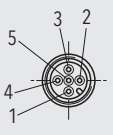
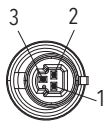
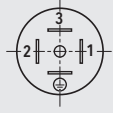
|               |   | Protection / electrical connection  |   |  |   |   |           |   |
|---------------|---|---|---|--|---|---|-----------|---|
|               |   | IP65*)  | IP67/IP68 max. 3m   | IP67*)   | IP67*)  | IP65  |           |   |
|               |   | Industrial standard<br>EN175301-803A **)  | Cable**) <b>22/68</b>   | M12x1 **)<br>5-pole <b>35</b>  | Packard Metri Pack **)<br>3-pole <b>51</b>  | Industrial standard<br>Contact distance<br>9.4 mm **) <b>01</b>                     |           |   |
|               |   |  |  |  |  |  |           |   |
| Output signal | <p><b>8471.xx.xxxx.xx.19</b></p>          | Standard  | <b>92</b>   |  |   | <b>E4</b>   |           |   |
|               | <p><b>8471.xx.xxxx.xx.14/16/17/23</b></p> | Standard  | <b>98</b>   | <b>97</b>  |   |   | <b>99</b> |   |
|               |   |   |   | white  |   |   |           | 2 |
|               |   |   |   | brown  | 4   | 1   | 1         | 1 |
|               |   |   |   | ⊖  | 1   | 2   | 3         | 1 |
|               |   |   |   | ⊖  | 5   |   |           | ⊖ |
|               |   |   |   |  |   |   |           |   |
|               |   |   |   | white  |   |   |           |   |
|               |   |   |   | green  | 2   | 1   | 1         | 1 |
|               |   |   |   | brown  | 4   | 3   | 2         | 2 |
|               |   |   |   | ⊖  | 3   | 2   | 3         | 3 |
|               |   |   |   | ⊖  | 5   |   |           | ⊖ |

\*) Provided female connector is mounted according to instructions

\*\*) Ventilation via male electric plug/cable end

\*\*\*) Only cable versions or female plug with shield connection

### Additional information

#### Documents

|              |  |
|--------------|--|
| Data sheet   | <a href="http://www.trafag.com/H72323">www.trafag.com/H72323</a> |
| Instructions | <a href="http://www.trafag.com/H73324">www.trafag.com/H73324</a> |
| Flyer        | <a href="http://www.trafag.com/H70689">www.trafag.com/H70689</a> |

| Additional specifications       |                                  |   |
|---------------------------------|----------------------------------|---|
| <b>Accuracy</b>                 | TEB max. @ -25 ... +85°C         | ± 6.0 % FS max.   |
|                                 | Accuracy @ 25°C max.             | ± 1.0 % FS max.   |
|                                 | NLH @ 25°C (BSL) max.            | ± 0.35 % FS max.  |
|                                 | NLH @ 25°C (BSL through 0) typ.  | ± 0.3 % FS typ.   |
|                                 | NLH @ 25°C (BSL through 0) max.  | ± 0.5 % FS max.   |
|                                 | Repeatability                    | ± 0.05 % FS typ.  |
|                                 | TC zero point and span max.      | ± 0.06 % FS/K max.  |
|                                 | Long term stability 1000h @ 85°C | ± 0.3 % FS typ.<br>± 0.6 % FS max.  |
|                                 | Temperature hysteresis           | ± 0.2 % FS typ.<br>± 0.6 % FS max.  |
| <b>Electrical Data</b>          | Resistance of insulation         | Type 14/16/17/23: > 10 MΩ, 100 VDC<br>Type 19: > 10 MΩ, 250 VDC   |
|                                 | Dielectric strength              | Type 14/16/17/23: 100 VAC, 50 Hz<br>Type 19: 250 VAC, 50 Hz   |
|                                 | Current limiting output signal   | 4 ... 20 mA: ca. 25 mA max.   |
| <b>Environmental conditions</b> | Storage temperature              | -25°C ... +85°C   |
| <b>EMC Protection</b>           | ESD                              | EN/IEC 61000-4-2<br>4 kV contact/ 8 kV air: no malfunction  |
|                                 | RFI                              | EN/IEC 61000-4-3<br>10V/m: 0.01...2700 MHz<br>(Output 4...20 mA, @ 600...900 MHz,<br>increased error < 3 %) |
|                                 | Burst                            | EN/IEC 61000-4-4<br>Burst ± 2 kV: no interference   |
|                                 | Surge                            | EN/IEC 61000-4-5<br>Surge 1.2/50μ ± 1 kV:<br>no interference  |
|                                 | Conducted Immunity               | EN/IEC 61000-4-6<br>Radio-frequency: no interference  |

## Modifications

| Index | Date    | Description   |
|-------|---------|---|
| 3     | 02/2009 | New data sheet  |
| 4     | 09/2009 | Output 16 (1...6 VDC) added   |
| 5     | 12/2009 | Page 2: Cable length added 1M, 3M, 5M   |
| a     | 12/2010 | Index changed to „a"<br>Page 2: Pressure connection 30 with notation <sup>1)</sup> „please ask us"<br>Page 2: O-Ring CR with notation $\leq 100$ bar<br>Page 2, 4: Accessories: Outputs 14,16,17,23: additional special electrical connection No. 97 added                                  |
| b     | 01/2011 | Spec-Sheet:<br>Deviation of zero signal and final value @ 25°C changed to $\pm 0.5$ % d.S. typ.<br>$\pm 1.0$ % d.S. max<br>„Electrical data" Resistance of insulation modified for types 14,16,17, 23 & 19<br>Dielectrical strenght added for types 14,16,17,23 and 19                      |
| c     | 05/2012 | Page 2: Measuring range in psi added<br>Page 5: Dimension of execution 05, 35, 22 modified  |
| d     | 06/2012 | All pages: Phase out of all brass variants, type ECERV, Sensor types 58 and 88  |
| e     | 07/2012 | Page 2: (IP68 max. 3m) Medium +10°C...+35°C max. 1bar rel/abs added<br>Page 5: Electrical Connection added IP68 max. 3m   |
| f     | 11/2012 | Page 2,5: Integration of male electrical plug „Packard Metri Pack"  |
| g     | 05/2013 | Page 2, 4: New sensors added<br>for relative pressure measurement: Nr. <b>52</b> steel 1.4462 & Nr. <b>53</b> Titan Grade 5<br>for absolute pressure measurement: Nr. <b>82</b> steel 1.4462 & Nr. <b>83</b> Titan Grade 5  |
|       | 10/2013 | Page 2, 5: Pressure connection <b>52</b> added, G 3/4" Frontal membrane<br>Page 5: Dimensions of all executions modified (05, 35, 51, 22)<br>Page 5: Electrical connections: both diagrams modified<br>Page 6: Spec-sheet: „Deviation of zero signal and final value" removed               |
| h     | 09/2013 | Page 2: Male electrical plug industrial standard added with code 01<br>Page 3: Accessories: Female electrical connector industrial standard code 34 added<br>Page 3: Pressure peak damping elements 0.4 mm added and 0.3 mm deleted<br>Page 5: Dimensions and electrical connection adapted |
| i     | 10/2013 | Page 3: Pressure peak damping element 0.4 mm removed;<br>0.3mm & 0.5mm added with ordering code 43 & 45 (previous state)  |
| k     | 02/2014 | Page 2: Footnote 5): More materials and cables with venting tubes for low pressure ranges upon request  |
| l     | 03/2014 | Page 5: Dimensions corrected executions 05 and 22   |
| m     | 05/2014 | New layout<br>NLH @ 25°C (BSL) as main specification and NLH @ 25°C (BSL through 0) as additional specification<br>Temperature indication added to O-ring type code elements<br>Electrical connection: remark added "ventilation via male electrical plug/cable"                            |
| n     | 06/2014 | Correction of IP protection for cable 22<br>Correction of graphics "electrical connection" (shield)   |
| o     | 11/2014 | Page 6: Electrical connection 01 Industrial standard: correction of indication 'contact distance 9.4' mm instead of EN175302-803A<br>Page 2/5: Removal of pressure connection G3/4" frontal membrane  |
| p     | 04/2015 | Additional specifications: Temperature hysteresis corrected from $\pm 0.4\%$ to $\pm 0.6\%$ FS max.   |
| q     | 06/2015 | Media temperature changed from -25°C...+85°C to -25°C...+125°C, inclusive O-Ring Code 61 and 63<br>Accessory Code 62: temperature changed from -25°C...+85°C to -25°C...+100°C  |
| r     | 11/2015 | Page 2: Relative sensors code 52 and 53 removed, absolute sensors code 82 and 83 removed<br>Page 3: Accessories: Pressure peak damping element code 44 added<br>Page 2, 3: Electrical connection code 22: Specification of temperature limit PVC cable -5 ... +60°C                         |



## Modifications

| Index | Date    | Description  |
|-------|---------|--|
| s     | 01/2016 | Correction of dimension valve opener 7/16-UNF female<br>Page 2: Range 71/G1: Overpressure corrected to 2 bar/30 psi and burst pressure corrected to 3 bar/40 psi   |
| t     | 03/2016 | Page 4: Addition of inverse-polarity protection, short-circuit strenght @ 25°C during 5 min.: 4...20 mA: to US = 30 VDC; 0...10 VDC, 0...5 VDC, 1...6 VDC: to US = 30 VDC; 0.5...4.5 VDC ratiometric: to US = 5.25 VDC   |
| u     | 07/2016 | Page 3: New accessory code <b>E4</b> : Special electrical connection: Pin 1 + , Pin 3 - (only for output 4...20mA and male electrical plug Packard Metri Pack 3-poles)<br>Page 3: Code <b>99</b> : information for electrical connection specified: only for output 0...5 VDC, 1...6 VDC, 0...10 VDC, 0.5...4.5 VDC and male electrical plug Packard Metri Pack 3-poles  |
| v     | 09/2016 | Page 4: Attributes Sensor, Pressure connection and housing separated: Sensor (wetted parts): Ceramic, Al <sub>2</sub> O <sub>3</sub> (96 %); Pressure connection (wetted parts): 1.4305 (AISI303); housing: 1.4305 (AISI303)   |
| w     | 11/2016 | Page 4: Environmental conditions: Protection IP67 and IP68 added<br>Page 5: 8471.XX.XXXX. <b>22</b> .XX.XX changed to 8471.XX.XXXX. <b>22/68</b> .XX.XX<br>Page 6: Electrical connection: IP65/IP68 max. 3m correctet to <b>IP67</b> /IP68 max. 3m   |
| x     | 12/2016 | Page 2: Typecode: Code <b>35</b> : Mat. PA (old Form), Mat. PBT (New Form), Code <b>51</b> : Mat. PBT and footnote 6) added<br>Page 5/6: New Dimensions Nr. <b>XX.35</b> New   |
| y     | 03/2017 | Page 3: Accessories code 40, 43, 44, 45: with footnote 7: only for pressure connection 30 (17 and 30 removed)<br>Page 2, 5: Pressure connection code 30, 1/4" NPT (typecode and dimensions): standard designation ANSI B1.20.1 added   |
| z     | 04/2017 | Page 5: Additional special pressure connection dimension code 24.05 (7/16"-20UNF female SAE J512 with valve opener, only with male electrical plug 05)   |
| aa    | 10/2017 | Information on front page: This product will be replaced by ECT 8472 data sheet H72324, EPI 8287, data sheet H72317<br>Features: Titan versoin optional removed<br>Page 5: Dimension and legend male electrical plug code 35 new shape removed<br>Page 5: Dimension and legend pressure connection 8471...24.05.. removed<br>Page 2: Relative and absolute sensor typecodes with new text "pressure connection and housing material" and with AISI designation |