

CANOPEN MINIATURE PRESSURE TRANSMITTER

Swiss based Trafag is a leading international supplier of high quality sensors and monitoring instruments for measurement of pressure and temperature. The CANopen miniature pressure transmitter CMP is based on Trafag's own thin-film-on-steel technology which offers high accuracy and longterm stability even in harsh environments. The most compact design and the proven high-performance electronics with CiA-certified, comprehensive CANopen-functionality makes the CMP 8270 best-in-class pressure transmitter.

CANopen®



Applications

- Engine manufacturing
- Railways
- Machine tools
- Hydraulics
- Process technology
- Test benches

Features

- Small and rugged construction
- Different accuracy classes
- Measurement of pressure and temperature
- CANopen bus protocol DS301/DS404 supports CAN 2.0A/B
- LSS (DS 305 V2.0)

03/2024

Data sheet H72614x

Technical Data			
Measuring principle	Thin-film-on-steel, piezoresistive	Accuracy @ 25°C typ.	± 0.5 % FS typ. ± 0.3 % FS typ. ± 0.15 % FS typ. ± 0.1 % FS typ.
Measuring range	0 ... 0.2 to 0 ... 600 bar 0 ... 3 to 0 ... 7500 psi	Media temperature	-50°C ... +135°C
Output signal	Bus protocol CANopen DS404	Ambient temperature	-40°C ... +125°C
NLH @ 25°C (BSL) typ.	± 0.3 % FS typ. ± 0.2 % FS typ. ± 0.15 % FS typ. ± 0.1 % FS typ.		

Subject to change

Ordering information/type code

				8270 . XX	XX	XX	XX	XX	XX
Measuring range ¹⁾	Pressure measurement range [bar]	Over pressure [bar]	Burst pressure [bar]	Pressure measurement range [psi]	Over pressure [psi]	Burst pressure [psi]			
	0 ... 0.2 ²⁾	1.2	25	0 ... 3 ²⁾	18	350	F8		
	0 ... 0.4 ²⁾	1.2	25	0 ... 5 ²⁾	18	350	F9		
	0 ... 0.6 ²⁾	1.5	25	0 ... 10 ²⁾	25	350	G0		
	0 ... 1 ²⁾	2	25	0 ... 15 ²⁾	30	350	G1		
	0 ... 1.6 ²⁾	3.5	50	0 ... 25 ²⁾	50	700	G3		
	0 ... 2.5 ²⁾	5	50	0 ... 30 ²⁾	60	700	G5		
	0 ... 4	12	100	0 ... 50	100	850	G6		
	0 ... 6	12	100	0 ... 100	200	1450	G7		
	0 ... 10	20	200	0 ... 150	300	2500	G8		
	0 ... 16	32	200	0 ... 200	400	2500	GA		
	0 ... 25	50	300	0 ... 250	500	2500	G9		
	0 ... 40	80	300	0 ... 300	600	4000	HA		
	0 ... 60	120	400	0 ... 400	800	4000	H0		
	0 ... 100	200	500	0 ... 500	1000	4000	H1		
	0 ... 160	320	750	0 ... 1000	2000	5000	H2		
	0 ... 250	500	1000	0 ... 1500	3000	7000	H3		
	0 ... 400	800	1500	0 ... 2000	4000	10000	H5		
	0 ... 600	1200	2000	0 ... 3000	6000	14500	G4		
	0.8 ... 1.2 ⁸⁾⁹⁾	2	4	0 ... 5000	10000	21750	H4		
				0 ... 7500	15000	29000	H6		
	Sensor	Relative pressure, accuracy: 0.5 % ⁵⁾	25	Absolute pressure, accuracy: 0.5 % ^{4) 5)}	45				
Relative pressure, accuracy: 0.3 %		23	Absolute pressure, accuracy: 0.3 % ^{4) 6)}	43					
Relative pressure, accuracy: 0.15 % ⁵⁾		21	Absolute pressure, accuracy: 0.15 % ^{4) 5)}	41					
Relative pressure, accuracy: 0.1 % ⁵⁾		24	Absolute pressure, accuracy: 0.1 % ^{4) 5)}	44					
Pressure connection	G1/4" male ⁹⁾						17		
	1/4" NPT male						30		
	1/4" NPT female ⁷⁾						13		
	7/16"-20UNF male ^{3) 4)}						18		
	7/16"-20UNF female, DIN3866 (valve opener) ^{3) 4)}						24		
	7/16"-20UNF-2A male, SAE J1926-2 (Heavy Duty) ^{3) 9) 11)}						69		
	9/16"-18UNF-2A male, SAE J1926-2 (Heavy Duty) ^{3) 9) 11)}						67		
M10x1 male, DIN EN ISO 6149-2 ^{3) 9)}						32			
Electrical connection	Male electrical connector M12x1, 5-pol., Mat. PA						35		
Output signal	CANopen bus protocol with pre-adjustment, Node-ID = 1, baudrate = 20 kbps							52	
	CANopen bus protocol with pre-adjustment, Node-ID = 1, automatic baudrate detection							53	
Accessories	Female electrical plug M12x1, 5-pole							33	
	Meets EN 50155 (Railway)							11	
	Pressure peak damping element ø 1.0 mm							40	
	Pressure peak damping element ø 0.3 mm							43	
	Pressure peak damping element ø 0.5 mm							45	

¹⁾ Extended overpressure as well as customized pressure ranges upon request

²⁾ Only with pressure connection 17 (G1/4") or 30 (1/4" NPT)

³⁾ Only for relative pressure

⁴⁾ Max. allowable pressure range 40 bar/600 psi

⁵⁾ Only for pressure ranges ≥ 4 bar / 50 psi

⁶⁾ Only for pressure ranges ≥ 1 bar / 15 psi

⁷⁾ Upon request

⁸⁾ Only with sensor 43 and pressure connection 17, 13, measuring principle piezoresistive

⁹⁾ Seal FKM, -18°C ... +125°C

¹¹⁾ Measuring range max. 630 bar according to SAE J1926-2 (Heavy Duty)

Dimensions

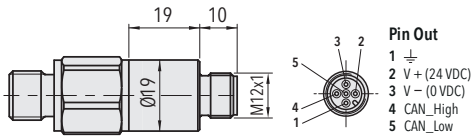

8270.XX.XXXX.35.XX.XX

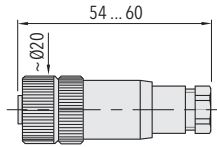

8270.XX.XXXX.XX.XX.33

Relative pressure ≤ 0 ... 2.5 bar

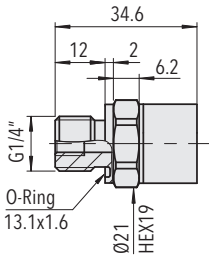

8270.XX.2X17.XX.XX.XX

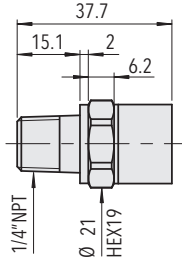

8270.XX.2X30.XX.XX.XX

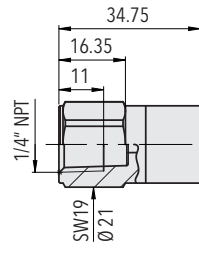

8270.XX.2X13.XX.XX.XX

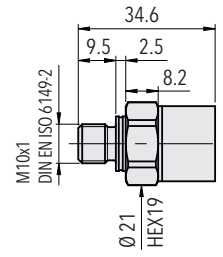

8270.XX.2X32.XX.XX.XX

Relative pressure > 0 ... 2.5 bar

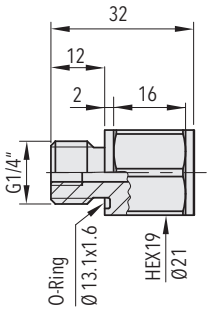

8270.XX.2X17.XX.XX.XX

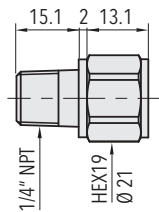

8270.XX.2X30.XX.XX.XX

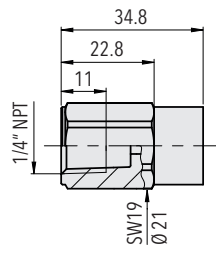

8270.XX.2X13.XX.XX.XX

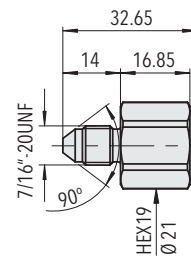

8270.XX.2X18.XX.XX.XX

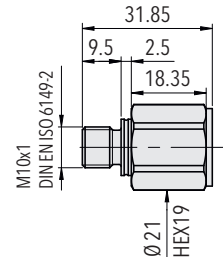

8270.XX.2X32.XX.XX.XX

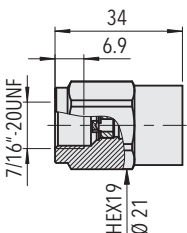

8270.XX.2X24.XX.XX.XX

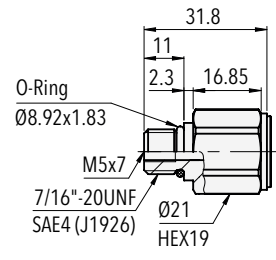

8270.XX.2X69.XX.XX.XX

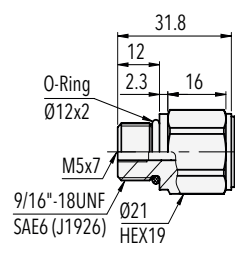

8270.XX.2X67.XX.XX.XX

Absolute pressure

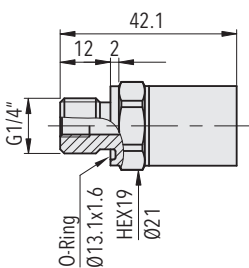

8270.XX.4X17.XX.XX.XX

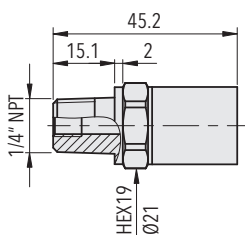

8270.XX.4X30.XX.XX.XX

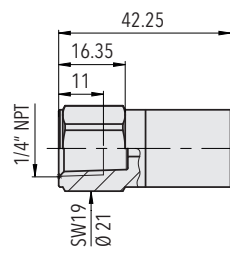

8270.XX.4X13.XX.XX.XX

Specifications ³⁾		
Electrical Data	Output / supply voltage	Bus protocol CANopen / 12/24 (8...32)VDC
	Rise time	Typ. 1 ms / 10 ... 90 % nominal pressure
	Current consumption / power consumption	ca. 20 mA
Environmental conditions	Media temperature	-50°C ... +135°C
	Ambient temperature	-40°C ... +125°C
	Protection ¹⁾	Min. IP67
	Humidity	Max. 95 % relative
	Vibration	40 g (20 ... 2000 Hz)
	Shock	100 g / 11 ms
EMC Protection	Emission	EN/IEC 61000-6-3
	Immunity	EN/IEC 61000-6-2
Mechanical Data	Sensor (wetted parts) ²⁾	1.4542 (AISI630)
	Pressure connection (wetted parts)	Pressure ranges ≤ 250 bar: 1.4542 (AISI630) Pressure ranges > 250 bar: 1.4301 (AISI304)
	Housing	1.4301 (AISI304)
	Sealing	FKM (-18°C ... +125°C)
	Male electrical connector	See ordering information
	Weight	~ 60 g
	Mounting torque	25 Nm

¹⁾ Provided female electrical plug is mounted according to instructions

²⁾ Measuring range B1:

Sensor (wetted parts): AISI316L

Pressure connection (wetted parts): 1.4301

³⁾ For accessory code 11 see separate table

Accuracy				
		Measuring accuracy 0.5 % Ordering No. 25/45	Measuring accuracy 0.15 % Ordering No. 21/41	Measuring accuracy 0.1 % Ordering No. 24/44
TEB @ -25 ... +85°C	[% FS typ.]	± 2.0	± 0.2	± 0.1
Accuracy @ +25°C	[% FS typ.]	± 0.5	± 0.15	± 0.1
NLH @ +25°C (BSL)	[% FS typ.]	± 0.3	± 0.15	± 0.1
TC zero point and span	[% FS/K typ.]	± 0.03	± 0.002	± 0.002
Long term stability 1 year @ +25°C	[% FS typ.]	± 0.2	± 0.1	± 0.1
Mounting dependency with 180° rotation (vibration and shock)	[% FS max.]	0.5 mbar	0.5 mbar	0.5 mbar
Signal of pressure sensor				
Resolution		≥ 10 bit @ 1 ms 13 bit @ ≥ 5 ms	≥ 10 bit @ 1 ms 13 bit @ ≥ 5 ms	≥ 10 bit @ 1 ms 13 bit @ ≥ 5 ms
Sampling rate (fix)		1ms (1 kHz)	1ms (1 kHz)	1ms (1 kHz)
Measuring filter (moving average)	[ms]	1 ... 65'000	1 ... 65'000	1 ... 65'000
Signal of temperature sensor				
Total error @ -25 ... +85°C	[°C typ.]	not calibrated	± 1	± 1
Sampling rate (fix)		10x100 ms (1 Hz)	10x100 ms (1 Hz)	10x100 ms (1 Hz)
Measuring filter (moving average)	[s]	0.1 ... 6500	0.1 ... 6500	0.1 ... 6500

Accuracy					
		Measuring accuracy 0.3 % Ordering No. 23/43			Measuring accuracy 0.3 % Ordering No. 43
Measuring range		≥ 0.2 bar ≤ 0.6 bar	> 0.6 bar < 2.0 bar	≥ 2.0 bar	0.8 ... 1.2 bar (code B1)
TEB @ -25 ... +85°C	[% FS typ.]	± 2.0	± 1.5	± 1.0	± 1.0
Accuracy @ +25°C	[% FS typ.]	± 0.8	± 0.6	± 0.3	± 0.3
NLH @ +25°C (BSL)	[% FS typ.]	± 0.2	± 0.2	± 0.2	± 0.2
TC zero point and span	[% FS/K typ.]	± 0.02	± 0.02	± 0.01	± 0.03
Long term stability 1 year @ +25°C	[% FS typ.]	± 0.3	± 0.2	± 0.1	± 0.3
Mounting dependency with 180° rotation (vibration and shock)	[% FS max.]		0.5 mbar		0.5 mbar
Signal of pressure sensor					
Resolution		≥ 10 bit @ 1 ms 13 bit @ ≥ 5 ms			≥ 10 bit @ 1 ms 13 bit @ ≥ 5 ms
Sampling rate (fix)		1ms (1 kHz)			1ms (1 kHz)
Measuring filter (moving average)	[ms]	1 ... 65'000			1 ... 65'000
Signal of temperature sensor					
Total error @ -25 ... +85°C	[°C typ.]	± 2			± 2
Sampling rate (fix)		10x100 ms (1 Hz)			10x100 ms (1 Hz)
Measuring filter (moving average)	[s]	0.1 ... 6500			0.1 ... 6500

Railway specifications (type code 11)			
Electrical data	Output / supply voltage	EN50155	Bus protocol CANopen / 24 VDC
	Interruptions of the voltage supply	EN50155	Class S1
	Switching between two supply voltages	EN50155	Class C1
Environmental conditions	Media temperature	EN50155	OT6 (-40°C ... +85°C)
	Ambient temperature	EN50155	OT6 (-40°C ... +85°C)
	Startup at low temperature	EN50155	-40°C
	Dry heat	EN60068-2-2	Be: 85°C, 6 h (in operation)
	Damp heat, cyclic	EN60068-2-30	Db: 55°C, Variant 1, 2 cycles (2 x 24 h)
	Switch-on extended operating temperature	EN50155	Class ST0
	Rapid temperature variations	EN50155	Class H1
	Vibration and shock	EN61373	Vibration: category 3 Shock: category 3
	Dielectrical strength	EN50155	750 VDC
	Resistance of insulation	EN50155	> 100 MΩ, 500 VDC
	Behavior in case of fire	EN45545-2	Weight: < 10 g Surface: < 0.2 m ²
EMC Protection	Emission	EN50121-3-2	-
	Immunity	EN50121-3-2 ²⁾	-

²⁾ Surge voltage on shield, shield connected on both sides

Additional information		
Documents	Data sheet	www.trafag.com/H72614
	Instructions	www.trafag.com/H73614 ; H73615; H73616



CANopen Features

- CiA conformance tested
- All CiA bus speeds: 10kbit/s...1Mbit/s
- Autobaud
- Supports 11/29 bit identifiers: CAN 2.0 A/B
- Frequency of measurement and transmission upto 1kHz
- Moving average filter: 1ms...65s (pressure)
- Additional PDO mode: delta and limit triggered
- All standardised data types for PDO's Floating point, integer with 32, 24, 16 bits
- Eligible, prefix adjustable units pressure: bar, Pa, psi, mmHg, mmWg, atm, at; temperature: °C, °F, K
- Auto-zero function
- Auto-Start-Mode for operation without master
- 4 Pressure - and 4 temperature thresholds with 8 free definable CAN messages
- Separate storage of parameters for communication and application
- Flash-Update
- Baudrate detection

CANopen- Bus Protocol

- Output signal: CAN BUS (ISO 118982)
- CANopen: DS301 V4.0
- Device profile: DS404 V1.2
- Baudrate (Autobaude): 10kbit/s...1Mbit/s
- Error control: Nodeguarding, Heartbeat
- Node ID: LSS (DSP 305 V2.0) fully implemented, proprietary
- No. of PDO's: 4 TX
- PDO modes: event-/time-triggered, remotely requested, sync (cyclic/acyclic)
- PDO linking: yes
- PDO mapping: yes
- No. of SDO's: 1 server
- Emergency message: yes