

Type MI 210

2-way solenoid valve
direct actuated, bistable

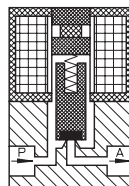

Application
Neutral liquids, gases
and vapors

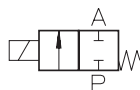

| Type/ Order No. | Orifice [mm] | Port size | Pressure range [bar] | | kv-value [m³/h] | Weight [kg] |
|--------------------|-----------------|-----------|----------------------|-------|--------------------|----------------|
| | | | AC | DC | | |
| MI 210-001 | 1,0 | M5 | - | 0 - 8 | 0,03 | 0,05 |
| | | | | | | |
| | | | | | | |
| | | | | | | |
| | | | | | | |

Sealing material: **P** (NBR) **E** (EPDM) **V** (FPM)

Body material: Brass
 Inner parts: Stainless steel (1.4105)
 Mounting direction: Free, preferred upwards
 Max. ambient temp.: 50 °C
 Viscosity of the medium: max. 21 mm²/s (3 °E)
 Static pressure: max. 10 bar
 Standard voltage: DC: 24 V, 12 V, 9 V, 6 V

Power consumption: 2,5 W
 Pulse duration: 30 ms
 Voltage tolerance: -15%... +10%
 Operating frequency: max. 300/min
 Degree of Protection: IP 54 (EN 60529)

308

Other configurations upon request

The right to modification is reserved

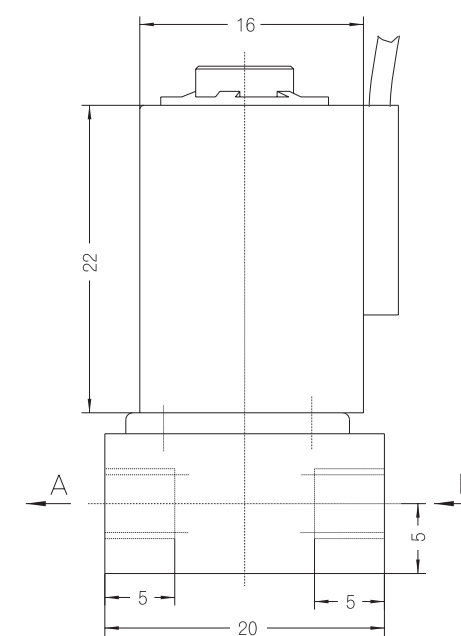
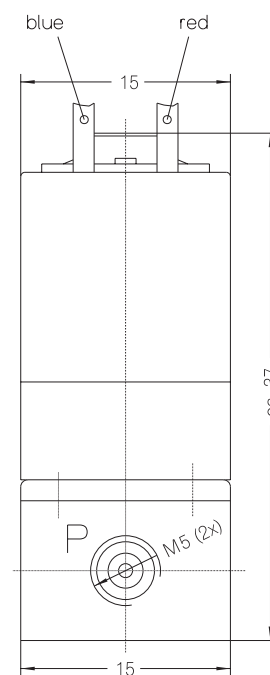

309



Dimensions in mm